

**NOTES:**

1. MASONRY WALLS TO BE PRIMED AS REQUIRED PRIOR TO FLASHING. WOOD WALLS REQUIRE BASE SHEET NAILED TO WALL 8" O.C. ALONG TOP AND LAPS, ONE PER S.F. FIELD.
2. DURAFLEX ALUM MAY BE USED FOR FLASHING MATERIAL IN LIEU OF HOT ASPHALT APPLIED SBS FLASHING MEMBRANE. DURAFLEX ALUM MAY ONLY BE APPLIED WITH HOT ASPHALT OR USING THE HEAT WELDING METHOD OR PLYLINK FLASH-N-PATCH. DO NOT USE SOLVENT BASED ADHESIVES TO INSTALL DURAFLEX ALUM.

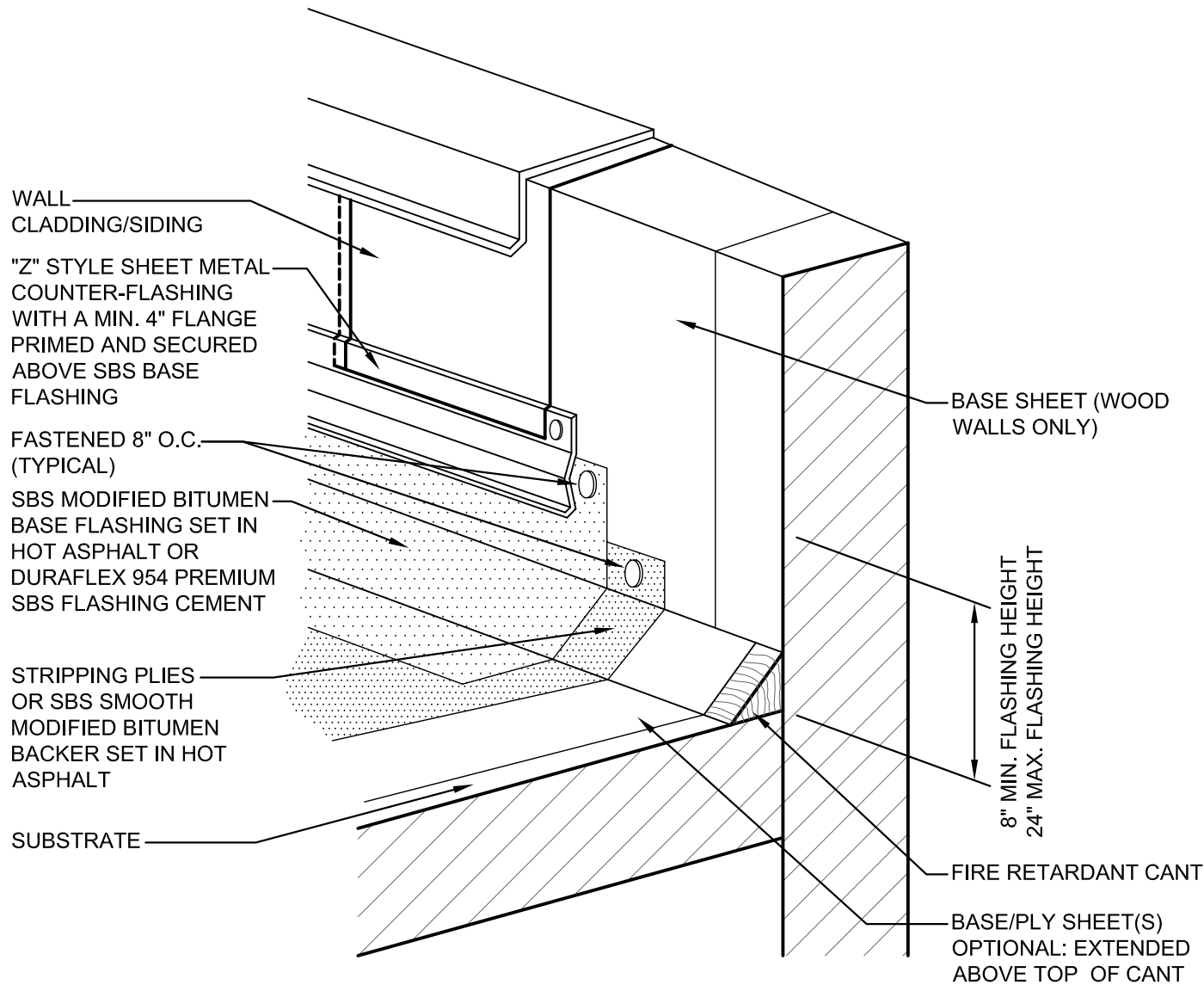

This detail is furnished "as is" and "as available" and for information only and as a guide for use in conjunction with U.S. Ply products with applicable construction conditions. All dimensions shown are sheet specific; do not scale off of drawing. All details must be checked by the user's designer, architect or engineer to ensure that design is adequate for intended use. Any alterations made to this detail become the design of the user and shall neither be assumed nor construed as U.S. Ply's design. U.S. Ply will not be liable for damages of any kind arising from the use of this website, and/or details, including direct, indirect, incidental, consequential and punitive damages.



**U.S. PLY, INC.**

*Pioneered with performance in mind... Engineered to stand the test of time.*

TITLE:  
**BUR HIGH WALL 2-PIECE FLASHING DETAIL**

DATE: <b>05-14-2004</b>	SCALE: <b>N.T.S.</b>
REVISIONS: <b>01-31-2011</b>	<b>BUR-14</b>