

TERM BAR

8" MIN. FLASHING HEIGHT  
24" MAX. FLASHING HEIGHT

FASTENED 8" O.C.  
(TYPICAL)

WOOD NAILER  
ATTACHED TO  
SUBSTRATE - OVERALL  
THICKNESS TO MATCH  
INSULATION

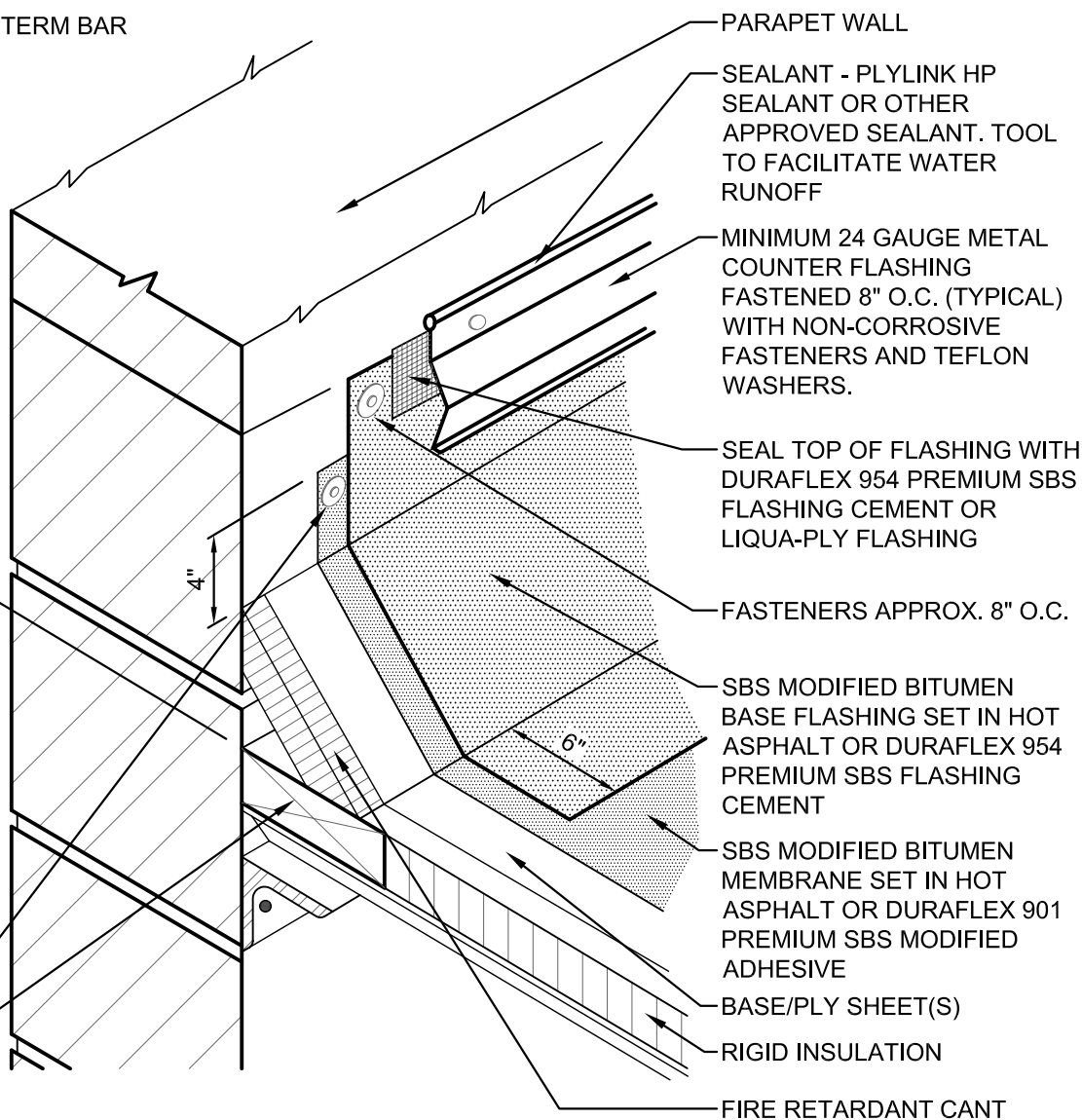

PARAPET WALL

SEALANT - PLYLINK HP  
SEALANT OR OTHER  
APPROVED SEALANT. TOOL  
TO FACILITATE WATER  
RUNOFF

MINIMUM 24 GAUGE METAL  
COUNTER FLASHING  
FASTENED 8" O.C. (TYPICAL)  
WITH NON-CORROSIVE  
FASTENERS AND TEFLON  
WASHERS.

SEAL TOP OF FLASHING WITH  
DURAFLEX 954 PREMIUM SBS  
FLASHING CEMENT OR  
LIQUA-PLY FLASHING

FASTENERS APPROX. 8" O.C.

SBS MODIFIED BITUMEN  
BASE FLASHING SET IN HOT  
ASPHALT OR DURAFLEX 954  
PREMIUM SBS FLASHING  
CEMENT

SBS MODIFIED BITUMEN  
MEMBRANE SET IN HOT  
ASPHALT OR DURAFLEX 901  
PREMIUM SBS MODIFIED  
ADHESIVE

BASE/PLY SHEET(S)

RIGID INSULATION

FIRE RETARDANT CANT

**NOTES:**

1. WHEN PARAPET WALL EXCEEDS 24" IN HEIGHT, REFER TO DURAFLEX SBS HIGH WALL FLASHING DETAIL.
2. MASONRY WALLS TO BE PRIMED PRIOR TO FLASHING. WOOD WALLS REQUIRE BASE SHEET NAILED TO WALL 8" O.C. ALONG TOP AND LAPS, ONE PER S.F. FIELD.
3. TERM BAR SHALL BE MINIMUM 1" WIDE EXTRUDED ALUMINUM, FASTENED 8" O.C. (TYPICAL) WITH NON-CORROSIVE FASTENERS AND TEFLON WASHERS.
4. TERM BAR, IN LIEU OF COUNTER FLASHING, IS NOT ACCEPTABLE FOR 15 AND 20 YEAR SYSTEMS.
5. DURAFLEX ALUM MAY BE USED FOR FLASHING MATERIAL IN LIEU OF HOT ASPHALT APPLIED SBS FLASHING MEMBRANE. DURAFLEX ALUM MAY ONLY BE APPLIED WITH HOT ASPHALT OR USING THE HEAT WELDING METHOD OR PLYLINK FLASH-N-PATCH. DO NOT USE SOLVENT BASED ADHESIVES TO INSTALL DURAFLEX ALUM.

This detail is furnished "as is" and "as available" and for information only and as a guide for use in conjunction with U.S. Ply products with applicable construction conditions. All dimensions shown are sheet specific; do not scale off of drawing. All details must be checked by the user's designer, architect or engineer to ensure that design is adequate for intended use. Any alterations made to this detail become the design of the user and shall neither be assumed nor construed as U.S. Ply's design. U.S. Ply will not be liable for damages of any kind arising from the use of this website, and/or details, including direct, indirect, incidental, consequential and punitive damages.



**U.S. PLY, INC.**

*Pioneered with performance in mind... Engineered to stand the test of time.*

TITLE:

**SBS COUNTER FLASHING DETAIL**

DATE:  
**05-14-2004**

REVISIONS:  
**01-31-2011**

SCALE:  
**N.T.S.**

**DF-5**