

**NOTES:**

1. SEE DURAFLEX TG SBS HIGH WALL FLASHING DETAIL FOR WALL FLASHING ABOVE 24".
2. SET SCUPPER FLANGES IN DURAFLEX 954 PREMIUM SBS FLASHING CEMENT - PRIME FLANGE BEFORE STRIPPING.
3. APPLY A BEAD OF DURAFLEX 954 PREMIUM SBS FLASHING CEMENT, LIQUA-PLY FLASHING OR PLYLINK CONSTRUCTION ADHESIVE/SEALANT TO THE MEMBRANE TERMINATION INSIDE SCUPPER AND AT SCUPPER OPENING CORNERS.
4. DURAFLEX ALUM MAY BE USED FOR FLASHING MATERIAL IN LIEU OF HEAT WELDED SBS FLASHING MEMBRANE.

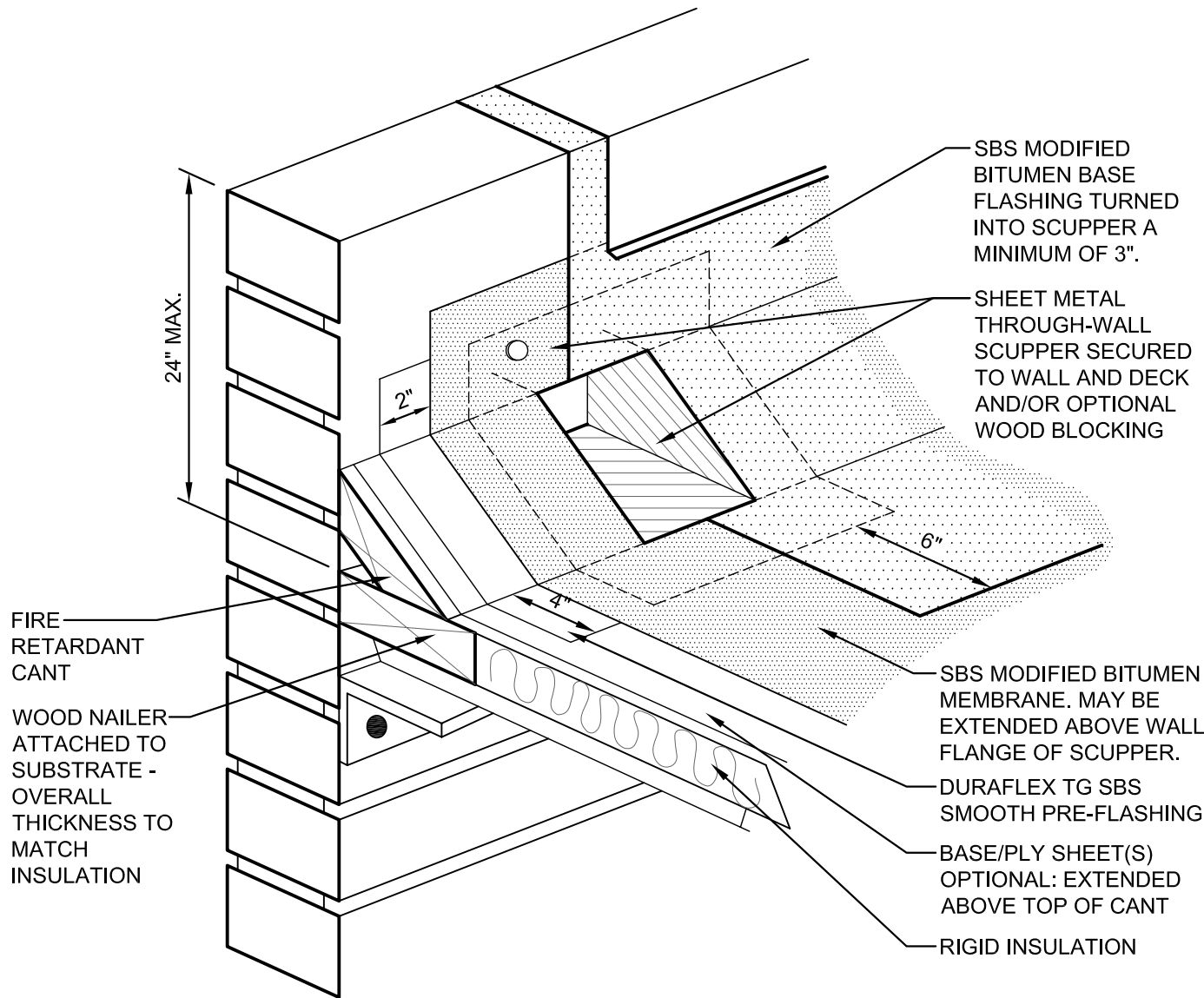

FIRE RETARDANT CANT

WOOD NAILER ATTACHED TO SUBSTRATE - OVERALL THICKNESS TO MATCH INSULATION

SBS MODIFIED BITUMEN BASE FLASHING TURNED INTO SCUPPER A MINIMUM OF 3".

SHEET METAL THROUGH-WALL SCUPPER SECURED TO WALL AND DECK AND/OR OPTIONAL WOOD BLOCKING

SBS MODIFIED BITUMEN MEMBRANE. MAY BE EXTENDED ABOVE WALL FLANGE OF SCUPPER.

DURAFLEX TG SBS SMOOTH PRE-FLASHING

BASE/PLY SHEET(S) OPTIONAL: EXTENDED ABOVE TOP OF CANT

RIGID INSULATION

This detail is furnished "as is" and "as available" and for information only and as a guide for use in conjunction with U.S. Ply products with applicable construction conditions. All dimensions shown are sheet specific; do not scale off of drawing. All details must be checked by the user's designer, architect or engineer to ensure that design is adequate for intended use. Any alterations made to this detail become the design of the user and shall neither be assumed nor construed as U.S. Ply's design. U.S. Ply will not be liable for damages of any kind arising from the use of this website, and/or details, including direct, indirect, incidental, consequential and punitive damages.



**U.S. PLY, INC.**

*Pioneered with performance in mind... Engineered to stand the test of time.*

TITLE:

**SBS ROOF SCUPPER FLASHING DETAIL**

DATE:  
05-14-2004

REVISIONS:  
01-31-2011

SCALE:  
N.T.S.

**DFTG-16**