

APP MODIFIED BITUMEN COVER FLASHING (INSTALL AFTER CURB HAS BEEN FLASHED)

FASTENERS APPROX. 8" O.C. (TYPICAL)

METAL FLASHING

FASTENERS APPROX. 24" O.C. (TYPICAL)

APP MODIFIED BITUMEN BASE FLASHING

APP MODIFIED BITUMEN MEMBRANE

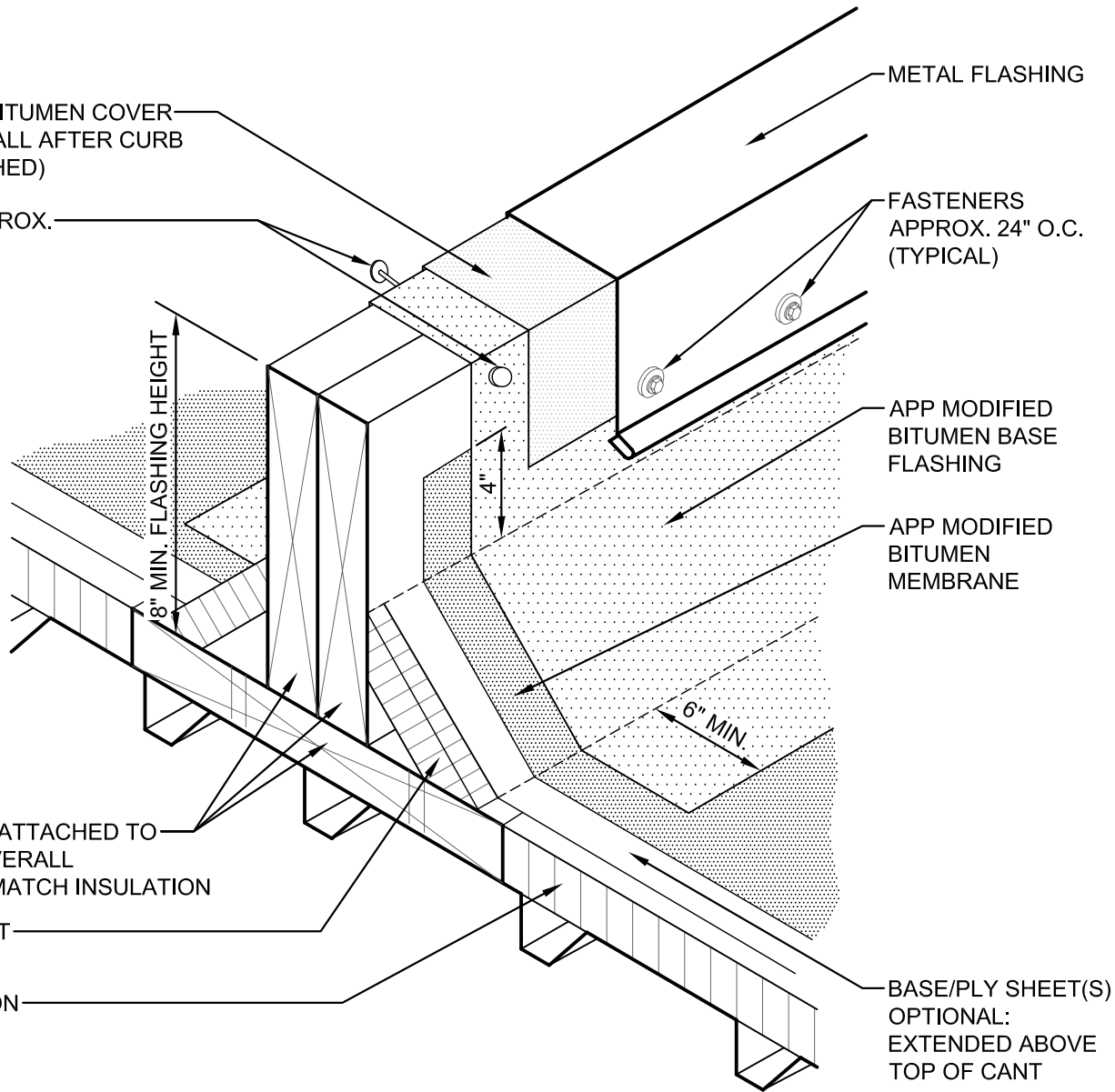

WOOD NAILERS ATTACHED TO SUBSTRATE - OVERALL THICKNESS TO MATCH INSULATION

FIRE RETARDANT CANT STRIP

RIGID INSULATION

BASE/PLY SHEET(S) OPTIONAL: EXTENDED ABOVE TOP OF CANT

This detail is furnished "as is" and "as available" and for information only and as a guide for use in conjunction with U.S. Ply products with applicable construction conditions. All dimensions shown are sheet specific; do not scale off of drawing. All details must be checked by the user's designer, architect or engineer to ensure that design is adequate for intended use. Any alterations made to this detail become the design of the user and shall neither be assumed nor construed as U.S. Ply's design. U.S. Ply will not be liable for damages of any kind arising from the use of this website, and/or details, including direct, indirect, incidental, consequential and punitive damages.



U.S. PLY, INC.

Pioneered with performance in mind... Engineered to stand the test of time.

TITLE:

APP CURB DIVIDER FLASHING DETAIL

DATE:
05-14-2004

REVISIONS:
01-31-2011

SCALE:
N.T.S.

DW-9