

TERM BAR

8" MIN. FLASHING HEIGHT
24" MAX. FLASHING HEIGHT

WOOD NAILER
ATTACHED TO
SUBSTRATE - OVERALL
THICKNESS TO MATCH
INSULATION

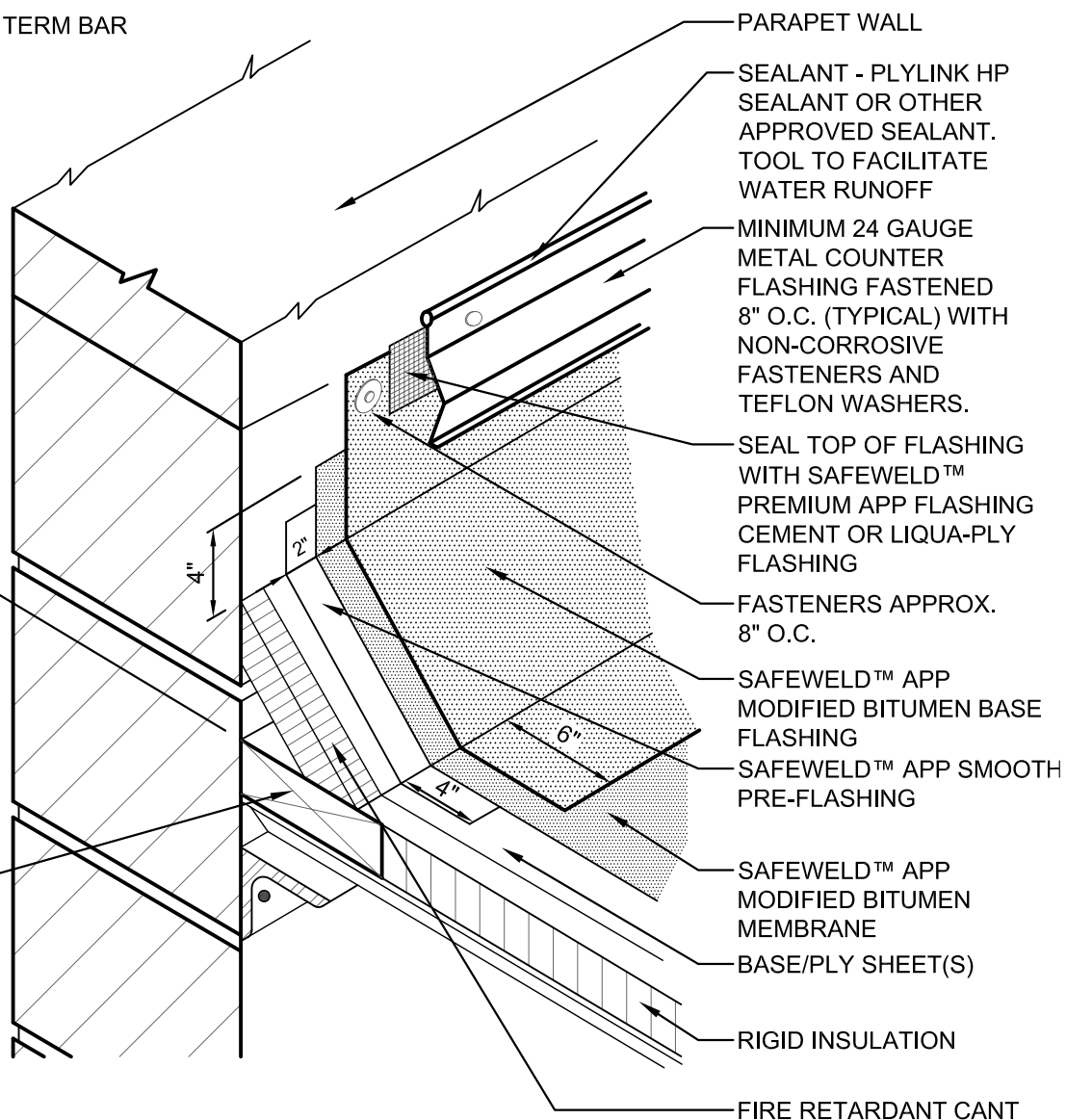

NOTES:

1. WHEN PARAPET WALL EXCEEDS 24" IN HEIGHT, REFER TO DURAWELD™ APP HIGH WALL FLASHING DETAIL.
2. MASONRY WALLS TO BE PRIMED PRIOR TO FLASHING. WOOD WALLS REQUIRE BASE SHEET NAILED TO WALL 8" O.C. ALONG TOP AND LAPS, ONE PER S.F. FIELD.
3. TERM BAR SHALL BE MINIMUM 1" WIDE EXTRUDED ALUMINUM, FASTENED 8" O.C. (TYPICAL) WITH NON-CORROSIVE FASTENERS AND TEFLON WASHERS.
4. TERM BAR, IN LIEU OF COUNTER FLASHING, IS NOT ACCEPTABLE FOR 15 AND 20 YEAR SYSTEMS.
5. SAFEWELD™ APP MEMBRANES MAY BE HEAT WELDED IN LIEU OF APPLICATION IN SAFEWELD™ PREMIUM APP MODIFIED ADHESIVE. REFER TO DURAWELD SPECIFICATIONS FOR HEAT WELDING PRECAUTIONS AND REQUIREMENTS.

This detail is furnished "as is" and "as available" and for information only and as a guide for use in conjunction with U.S. Ply products with applicable construction conditions. All dimensions shown are sheet specific; do not scale off of drawing. All details must be checked by the user's designer, architect or engineer to ensure that design is adequate for intended use. Any alterations made to this detail become the design of the user and shall neither be assumed nor construed as U.S. Ply's design. U.S. Ply will not be liable for damages of any kind arising from the use of this website, and/or details, including direct, indirect, incidental, consequential and punitive damages.



U.S. PLY, INC.

Pioneered with performance in mind... Engineered to stand the test of time.

TITLE:

APP COUNTER FLASHING DETAIL

DATE:
05-14-2004

SCALE:
N.T.S.

REVISIONS:
01-31-2011

SW-5